

Cocktails o'clock!

Give a retro trolley an extra pop of colour to create a super quirky drinks cart

The wall colour is Resene Divine



Go to www.good.net.nz/drinks to make this yummy spiced ginger drink. For more projects see www.facebook.com/reclaimthat

WORDS AND STYLING SARAH HEERINGA

A keen upcycler, Sarah loves giving old objects a second life



TONY BROWN/JOHN



YOU WILL NEED

- Resene testpots in selected colours
- Small paintbrushes and mini roller
- Scissors, quality masking tape, cloth and razor paint scraper
- Resene anaglypta paper wallpaper
- Strong paper glue
- Resene Aquaclear waterborne urethane varnish
- Medium-sized paintbrush



Small projects are ideal for practising your painting skills – and playing around with new techniques. On the top tray I painted lines and triangles. On the bottom I glued painted shapes using Resene anaglypta wallpaper, which is heavily embossed and looks like pressed tin plate once painted. Resene testpots are perfect when you need only small amounts of paint, and let you have fun with your colour combinations.

I used Resene Renew, Resene Dali, Resene Boutique, Resene Half Putty, Resene Smitten and Resene Gold Dust.

HOW TO

1. Check the surface is clean and dry. Use masking tape to create straight painted lines. Ensure the tape has stuck fully to the painting surface by pressing down all edges using the back of a spoon.
2. Apply two coats of each colour, allowing drying time between each coat.
3. Carefully remove the tape strips. Use the small paintbrush or razor scraper to tidy wobbly edges or remove any excess paint. Seal with Resene Aquaclear varnish.
4. Cut anaglypta paper to shape and paint.
5. Once strips are dry, glue into place.
6. Clean off any extra glue and give tray surface a final coat of clear varnish.

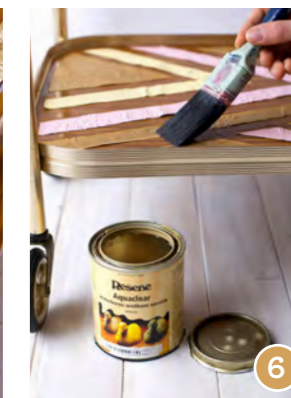
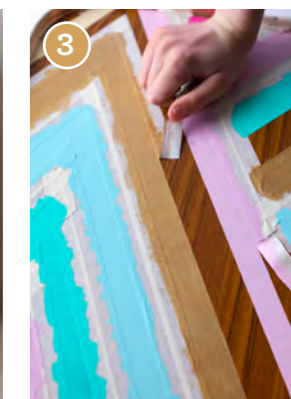

For more great makeover projects go to www.good.net.nz/athome

Call 0800 RESENE (737 363) visit www.resene.co.nz or email advice@resene.co.nz

Resene
the paint the professionals use