



# memories are made of this

Take one special image and use it to inspire a memory board for your photos and memorabilia.



## You will need

- Half a sheet of grooved plywood, 1200mm x 1200mm
- Four lengths of 300mm x 50mm beading for the frame
- Handsaw and mitre box
- Testpots of your chosen colours: we used Resene Triple Pearl Lusta, Resene Jordy Blue, Resene Evolution, Resene Double Pavlova.
- Paint brush
- Coarse 80-grit sandpaper and sanding block
- Liquid nails and clamps

- |   |                           |   |                       |
|---|---------------------------|---|-----------------------|
|  | Resene Triple Pearl Lusta |  | Resene Evolution      |
|  | Resene Jordy Blue         |  | Resene Double Pavlova |



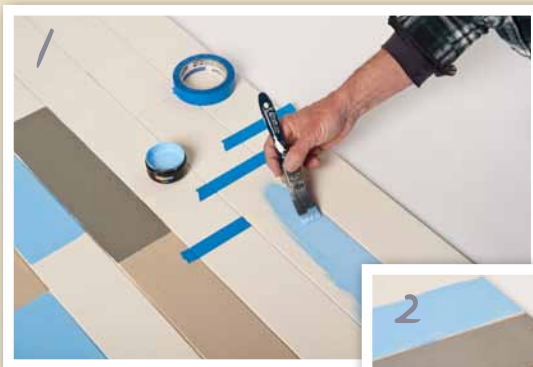

## *To start*

Choose your favourite image and upload it to the Resene Colour Palette Generator at [www.resene.com/picturepalette](http://www.resene.com/picturepalette) to create your colour scheme, or use the new Resene ColourMatch app for iPhone or Android.

## *Step 1*

Using the lightest of the colours, give the entire board one coat of paint.

Using the other colours, paint each 'board' a different colour leaving some in the base colour or in sections as we have done, again leaving some in the base colour. Don't worry if it looks a little patchy; you want an aged look anyway.

## *Step 2*

Sand back the topcoat colours for a distressed effect. Use a sanding block and sandpaper, pull the block in one or two firm strokes along the boards. Don't worry if you get it wrong as you can just repaint another topcoat and sand again.

## *Step 3*

Paint the framing timber in the lighter basecoat. Measure to fit the sides (it will sit on top), and mitre the corners.

## *Step 4*

Fix to the top of the board using liquid nails. Clamp if necessary while drying.

styling Sharon Newey and Lisa Morton  
crafting Philippe Morin  
pictures Tony Brownjohn